



## Enjoy Peace of Mind

- ❖ The refurbishment service covers, Dome Valve<sup>®</sup>, Rotary Vent Valve, RotoFeeder<sup>®</sup> and MULTICOR<sup>®</sup>. The refurbishment service covers a fixed scope of work and includes all labour and parts. Additional items which come to light during the pre-inspection strip down, and which is outside the fixed scope of supply will be quoted separately prior to any work commencing.
- ❖ All work and parts guaranteed for 12 months (excluding consumable Dome Valve<sup>®</sup> insert seals).
- ❖ Detailed inspection report issued prior to work commencing (including total cost).
- ❖ Inspection report issued within 48 hours of receiving the equipment subject to parts availability.
- ❖ Refurbished equipment delivered usually within 5 days of instructions to proceed subject to parts availability.
- ❖ The equipment is stripped down, refurbished with new parts only if required, repainted and tested prior to dispatch.
- ❖ Wearing parts (seals and bearings etc) are always replaced.



### How to contact us:



**Schenck Process UK Limited**  
 Alpha Court, Capitol Park  
 Thorne, Doncaster  
 DN8 5TZ, United Kingdom

#### Aftermarket Service

Tel: +44 (0) 845 201 4562  
 Fax: +44 (0) 845 201 4563  
 service@schenckprocess.co.uk

#### Aftermarket Spares

Tel: +44 (0) 845 201 4564  
 Fax: +44 (0) 845 201 4565  
 spares@schenckprocess.co.uk

www.schenckprocess.co.uk

## Refurbishment Services



A fixed scope of work including labour and parts from Schenck Process Aftermarket Service to improve process efficiencies

01/14. All information is given without obligation.  
 All specifications are subject to change.

BV-P 9025 GB

©Schenck Process UK, 2014



## Scope of Work

### CLYDE PROCESS DOME VALVES®

- ❖ Inspect top plate for abrasive wear and replace if required.
- ❖ Inspect Dome condition, and replace if required.
- ❖ Replace shaft bearings and seals.
- ❖ Inspect and replace shaft if required.
- ❖ Lubricate both shaft and bearing sets.
- ❖ Replace Insert Seal.
- ❖ Inspect cylinder torque arm bush and replace if required.
- ❖ Check condition of cylinder/vane actuator and replace if required.
- ❖ Check and verify operation of pneumatic limit switch and replace if required.
- ❖ Check operation and calibrate set point for inflatable seal pressure switch (where fitted).
- ❖ Internal and external de-scale and repaint.
- ❖ Test the operation of equipment and issue certificate of conformity.

### MULTICOR®

- ❖ Replace worn or damaged measuring wheels, measuring shaft bearings and seals, couplings, gear box and motor.
- ❖ Renew worn measuring wheel housings and feed chutes.
- ❖ Check load cell mounting and mechanisms for material accumulation and corrosion; and check tare calibration and material on line calibration settings.

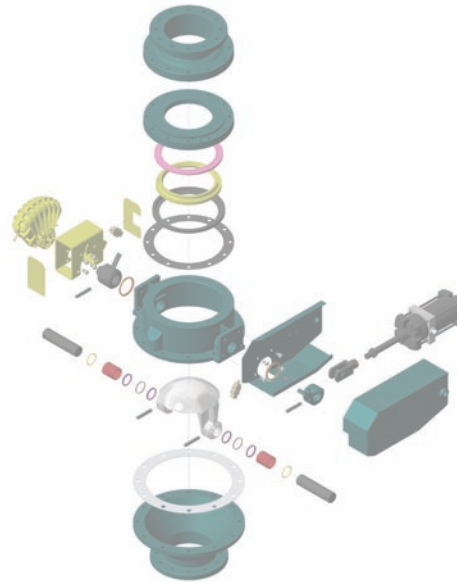

### ROTARY VENT VALVES, DUMP VALVES, PINCH VALVES, ROTARY VALVES

- ❖ Replace valve sealing head.
- ❖ Check top plate for wear and replace if required.
- ❖ Replace shaft bearings and seals.
- ❖ Lubricate shaft and bearings.
- ❖ Inspect and replace shaft if required.
- ❖ Check condition of cylinder and replace if required.
- ❖ Internal and external de-scale and repaint.
- ❖ Test the operation of equipment and issue of conformity.

### ROTOFEEDER® (EXCLUDING MOTOR DRIVE)

- ❖ Inspect top plate for abrasive wear and replace if required.
- ❖ Inspect and replace the agitator if required.
- ❖ Inspect rotor for abrasive wear and replace or reset as required.
- ❖ Inspect body for abrasive wear and replace if required.
- ❖ Replace drive shaft bearings and seals.
- ❖ Lubricate shaft and bearings.
- ❖ Inspect shaft for wear/misalignment and replace if required.

### ROTOSCREW®

#### Drive End Assembly

- ❖ Replace shaft bearings and seals.
- ❖ Replace all roll pins and dowel pins.
- ❖ Reset face seals using shim packs (where used).
- ❖ Pressure test.

#### Ancillary Services

- ❖ Replace shaft bearings and seals.
- ❖ Complete vessel assemblies.
- ❖ Upgrade pneumatic panels.
- ❖ Pressure test.

